

Reini®

MÄKI-REINI OY

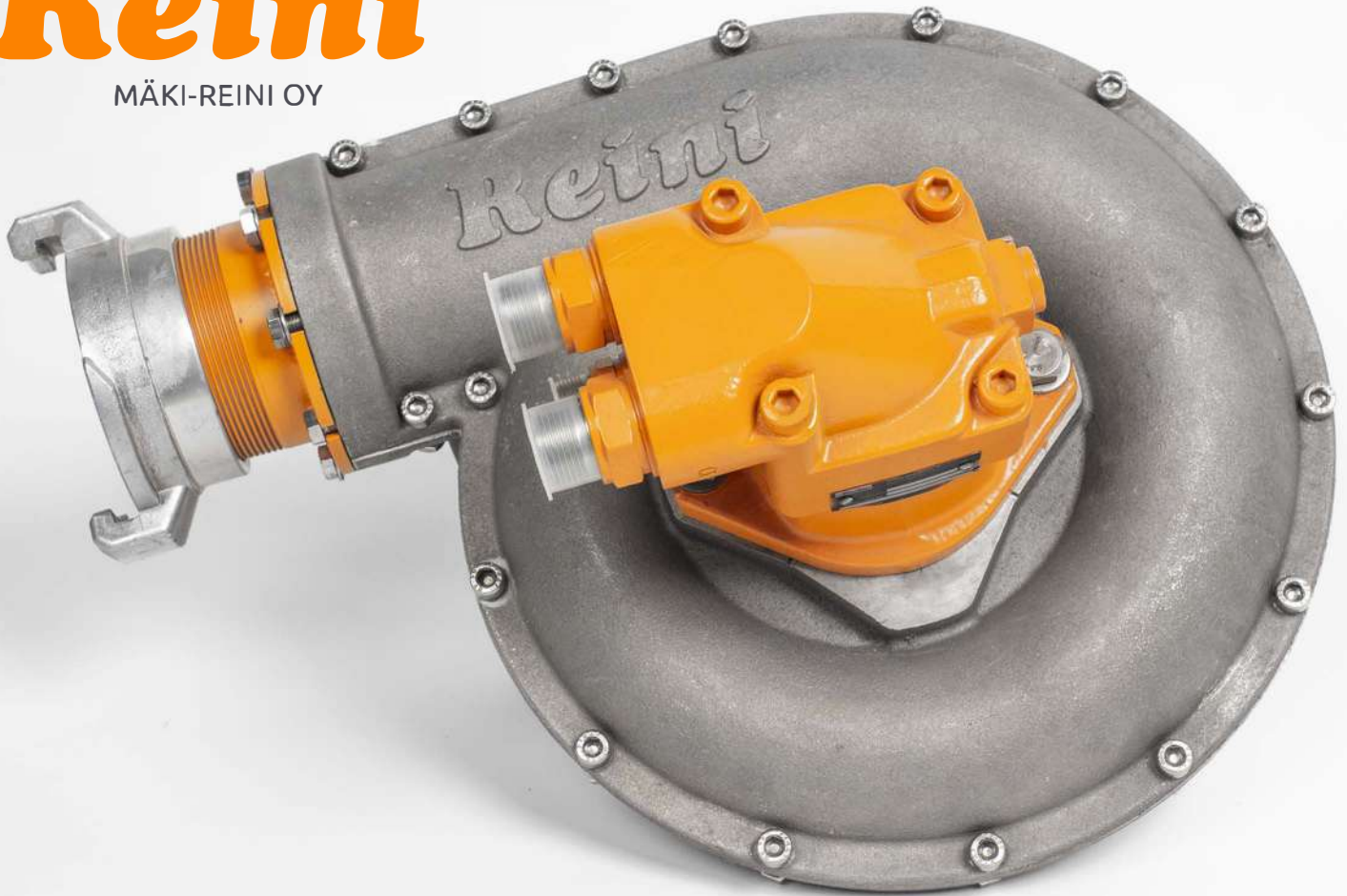

Reini PP3 Booster pump

Hydraulic driven high pressure pump for cleaning and fire-fighting tasks.

The frame and impeller is made of high quality aluminium. Suitable for pumping clean water. Tolerates dry running. Simple construction and maintenance-free.

The design of booster pump permits varied mounting options. Hydraulic motor can be installed in four different positions. Flange mountings in a suction and pressure connections which allows a wide range in a variety installations. The pump can be used also as a submersible pump individually.



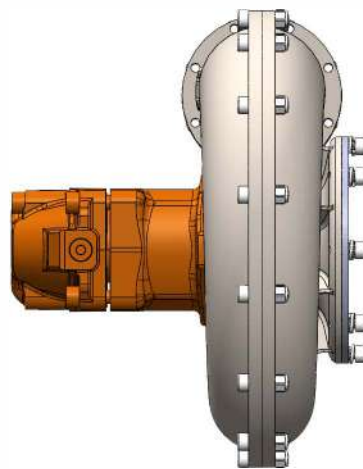
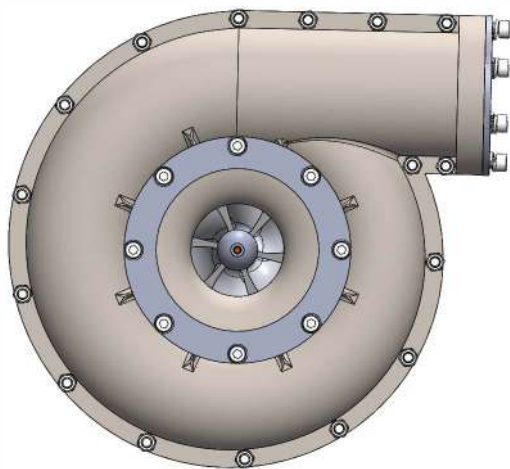
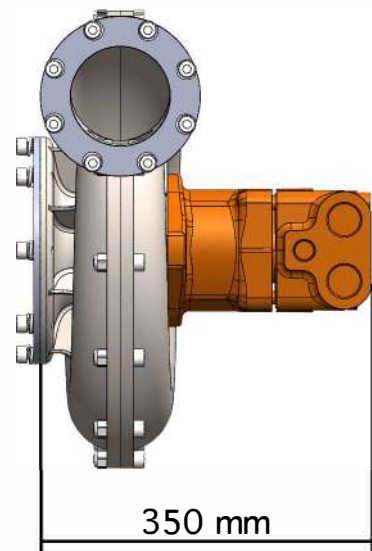
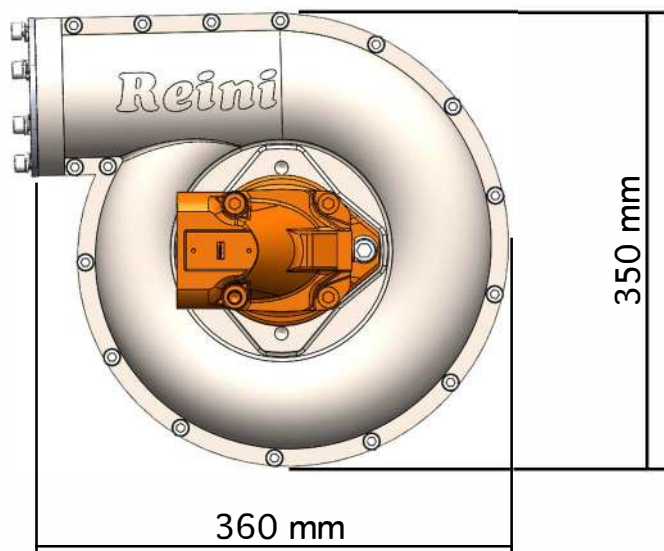

TECHNICAL DATA:

- Max allowed hydraulic pressure 350 bar
- Max allowed hydraulic flow 95 l/min
- Hydraulic connections:
 - pressure 3/4" internal thread
 - return 3/4" internal thread
 - drain line 3/8" internal thread
- Output without pressure 950 l/min
- Water pressure max 14 bar
- Inlet connection 4"
- Outlet connection 3"

Reini®
MÄKI-REINI OY

